

PARTS LIST

ORDERING INSTRUCTIONS

The following information must accompany all correspondence or repair parts orders:

1. Hoist model number.
2. Serial number of hoist and/or motor driven trolley.
3. Voltage, phase, hertz. This information is stamped on the hoist nameplate. The motor driven trolley serial number is stamped on end of motor side frame.

When ordering hoist and/or trolley parts, give the motor nameplate data in addition to the above.

For more information contact:
American Crane & Equipment Corp.
Authorized Distributor
Tel: 877-503-2972
Fax: 484-945-0430
sales@americancrane.com
www.americancrane.com

For parts orders specify:

1. Quantity desired.
2. Key number of part.
3. Part name.

NOTE: When ordering replacement parts, consider the need for such items as gaskets, oil seals, fasteners, etc. These items may be damaged or lost during the disassembly or may be unfit for future service because of deterioration from age or service conditions.

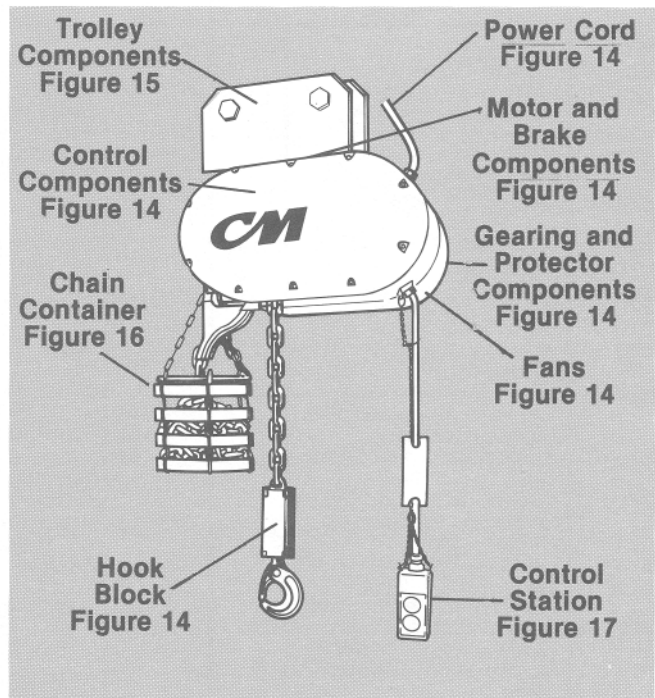

Figure 13. Parts Illustration Key

Table 9. Parts List-Series 670 Electric Chain Hoist-2 thru 6 ton

NOTE: NOT EVERY PART LISTED BELOW IS USED ON EVERY MODEL

Key No.	Part Name	No. Req'd.	Key No.	Part Name	No. Req'd.	Key No.	Part Name	No. Req'd.
670-8	Warning Tag	1	670-44	Intermediate Gear Retainer Ring	1	670-67	Bearing Retainer Screw—Control Side	4
670-10	Access Cover	1	670-45	Intermediate Gear	1	670-68	Adjusting Access Cover Screw With Seal Washer	1
670-11	Access Cover Gasket	1	670-46	Second Reduction Pinion	1	670-69	Adjusting Access Cover	1
670-12	Access Cover Screw	4	670-47	Second Reduction Pinion Bearing—Main Frame Side	1	670-70	Adjusting Access Cover Gasket	1
670-16	Brake Intermediate Plate	2	670-48	Second Reduction Pinion Bearing—Cover Side	1	670-71	Protector Adjusting Tool	1
670-17	Brake Friction Disc	3	670-49	Chain Anchor Pin Screw, Washer and Lockwasher	1	670-72	Liftwheel Pinion	1
670-19	Brake Spring	3	670-50	Gear Cover	1	670-73	Liftwheel Pinion Bearing—Cover Side	1
670-23	Motor (Includes Items 670-24, 670-25, 670-26, 670-28, 670-29, 670-31, 670-32, and 670-198)	1	670-51	Motor Cover	1	670-74	Shaft Adapter	1
670-24	Motor Stator (Includes Item 670-32)	1	670-52	Liftwheel Gear	1	670-75	Clutch Disc	2
670-25	Motor Rotor and Shaft Assembly (Includes Items 670-28 and 670-29)	1	670-53	Bearing Retainer Screw—Gear Side	4	670-76	Disc Spring	2
670-26	Motor End Bell with Brake Studs	1	670-54	Bearing Retainer—Gear Side	1	670-77	Second Reduction Gear Bushing	1
670-28	Motor Bearing—Brake End	1	670-55	Liftwheel Gear Retainer Ring	1	670-78	Second Reduction Gear Adjusting Sprocket (Includes Pins)	1
670-29	Motor Bearing—Main Frame End	1	670-56	Liftwheel Gear Bearing	1	670-79	Protector (Includes Items 670-74 thru 670-79)	1
670-31	Motor Thru Bolt and Lockwasher	4	670-57	Bearing Oil Seal Retainer Gasket	1	670-80	Protector Retainer Ring	1
670-32	Motor Thermal Switch	1	670-58	Bearing Oil Seal Retainer	1	670-81	Liftwheel Pinion Bearing—Main Frame Side	1
670-33	Motor Shaft Oil Seal	1	670-59	Bearing Oil Seal Retainer Screw	4	670-82	Main Frame Assembly (Caution: Frame Components are assembled and then machined as a unit. DO NOT attempt to disassemble components.)	1
670-34	Load Chain (Specify Length Required)	1	670-60	Liftwheel Gear Oil Seal	1	670-83	Gear Cover Gasket	1
670-35	Control Cable (Specify Length Required)	1	670-61	Liftwheel Gear Expansion Plug	1	670-84	Shroud Gasket	2
670-37	Chain Guide Threaded	1	670-63	Liftwheel	1	670-85	Shroud Assembly (Includes Access Door and Screws)	1
670-38	Chain Guide—Plain	1	670-64	Liftwheel Bearing	1			
670-41	Stripper	1	670-65	Liftwheel Bearing Retainer Ring	1			
670-42	Brake Hub Retainer Ring	1	670-66	Bearing Retainer—Control Side	1			
670-43	Brake Hub	1						

(Continued on page 24)

PARTS LIST (Continued)

Key No.	Part Name	No. Req'd	Key No.	Part Name	No. Req'd	Key No.	Part Name	No. Req'd
670-87	Shroud Stud	6	670-143	Control Panel Mounting Screw	1	670-204	Thermostat Wiring Harness	1
670-88	Breather Vent	1	670-144	Control Panel Mounting Screw Nut	1	670-205	Terminal Board with Mounting Hardware	1
670-89	Identification Plate and Attaching Screws	1	670-145	Plug—Main Frame (not shown)	1	670-206	Fan Screen	1
670-90	Warning Label	1	670-146	Control Cable Connector	1	670-207	Fan with Mounting Hardware	2
670-91	Protector Label (not shown)	1	670-147	Spring Container	1	670-208	Transformer with Spacer and Mounting Hardware (575-3-60 and 380-3-50 units only)	1
670-92	Gear Cover Screw and Seal	10	670-148	Spring Container Screw (5/16 Dia.) and Nut	2	670-209	Fan Power Wiring Harness	1
670-93	Motor Cover Nut and Seal	6	670-149	Spring Container Screw (3/8 Dia.) and Nut	2	670-211	Air Baffle & Mtg. Screws	1
670-94	Locator Dowel	2	670-150	Chain Hanger Nut	1	670-212	Coil Housing Assembly (Contains Housing 670-194, 670-214, 670-215, 670-216, 670-217, 670-218, 670-226, 670-246 and 670-247)	1
670-95	Cover Plate	1	670-151	Pin—Chain Hanger Nut	1	670-213	Components Board Assembly (Contains 670-219, 670-220, 670-221, 670-222, 670-224 and 670-225)	1
670-96	Cover Plate Screw	2	670-152	Chain Hanger	1	670-214	Coil Retainer	1
670-98	Access Door With Gasket Screws	1	670-153	Pin—Chain Hanger with Cotter Pins (2)	1	670-215	Coil Retainer Screw	1
670-100	Loose End Attachment (Includes Screw, Washer and Lockwasher)	1	670-154	Guide Seat	1	670-216	Brake Nut Retainer Spring and Mounting Hardware (Includes Spring, Screw, Washer and Lockwasher)	3
670-101	Stripper Mounting Screw and Lockwasher	1	670-155	Pressure Plate	1	670-217	Brake Nut Spring	3
670-102	Chain Guide Mounting Screw and Lockwasher	5	670-157	Spacer—Double Reduction Gearing (not shown)	1	670-218	Brake Nut Retaining Ring	3
670-103	Oil Drain Plug	1	670-158	Intermediate Gear Bushing—Double Reduction Gearing	1	670-219	Components Board Resistor	1
670-104	Oil Level Plug	1	670-159	Idler Gear—Double Reduction Gearing	1	670-220	Resistor	1
670-105	Control Cable Clip (Specify number required)	1	670-160	Adjustable Screw Limit Switch Assembly Complete, Specify single or double reduction—See Page 13.	1	670-221	Resistor Insulator	2
670-106	Control Station Chain (Specify length required)	1	670-162	Limit Switch Bracket Kit (Includes bracket and shaft bushing)	1	670-222	Resistor Mounting Hardware (Includes Screw, Lockwasher and Nut)	1
670-107	Motor Pinion Retainer Ring	1	670-163	Limit Switch Kit (Includes Switch Assembly and Mounting Screw)	1	670-223	Cutout Switch Actuator Screw, Nut and Lockwasher	1
670-109	Motor Pinion	1	670-167	Jumper	4	670-224	Rectifier/Varistor and Mounting Hardware (Includes Rectifier, Screw, Lockwasher and Nut)	1
670-110	Hook Nut Pin	1	670-168	Terminal Board	1	670-225	Jumper Kit (Includes 3 Jumpers, 2 Screws, 2 Lockwashers and 2 Nuts)	1
670-111	Hook Nut	1	670-169	Gear Train Bracket	1	670-226	Brake Coil	1
670-112	Hook Washer	1	670-170	Drive Gear	1	670-246	Coil Retainer Wave Spring	1
670-113	Limit Ring	2	670-171	Limit Switch Drive Shaft and Snap Ring	1	670-247	Cutout Switch and Mounting Hardware (Includes Switch, 2 Spacers, 2 Screws, 2 Lockwashers and Insulator)	1
670-114	Hook Block Disc Spring	33	670-172	Limit Switch Shaft and Gear Kit (Includes Shaft, 2 Traveling Nuts, Gear Shaft, Spring, Shaft Washer, Guide Plate, 2 Screws and Single Reduction Idler Gear or Double Reduction Intermediate Gear)	1	670-256	Control Station (See Page 32)	1
670-115	Hook Bearing	1	670-173	Jumper (14A)	1	670-258	Coil Insulating Washer	1
670-116	Latchlok Hook	1	670-174	Jumper (20A)	1	670-259	Coil Retainer Cushion Cover	1
670-117	Hook Block Screw (5/16 Dia.) and Nut	2	670-175	Gear Bushing	1	670-270	Enclosure with screws	1
670-118	Hook Block Screw (3/8 Dia.) and Nut	2	670-176	Drive Shaft Bushing	1	670-271	Switch Insert (Specify number required)	1
670-119	Half Link	1	670-177	Idler Gear Bushing	1	670-275	Push Button Chain Clip	1
670-120	Hook Block	2	670-178	Idler Gear Pin	1	670-281	Push Button Connector	1
670-121	Chain Anchor	2	670-181	Terminal Board Screw	2	670-282	Terminal Base (Specify number required)	1
670-122	Chain Anchor Pin	1	670-182	Idler Gear Washer	1	670-284	Reducer	1
670-123	Chain Anchor Screw	4	670-183	Drive Shaft Pin	1			
670-124	Hook Block Sheave	1	670-184	Drive Gear Pin	1			
670-125	Hook Block Sheave Bearing	2	670-185	Limit Switch Bracket Screw	2			
670-126	Hook Sleeve	1	670-187	Limit Switch Locator Bushing	2			
670-127	Hook Block Screw and Nut	3	670-188	Limit Switch Assembly Mounting Screw and Washer	2			
670-128	Control Cable Chain Clip	1	670-194	Hex Adjusting Nut	3			
670-129	Control Cable Chain Attaching Link (Specify number required)	1	670-195	Cap Plug—Main Frame	1			
670-130	Control Panel	1	670-196	Brake Hub Spacer	1			
670-131	Hoist Reversing Contactor Mounting Screw	2	670-197	Brake Instruction Label (not shown)	1			
670-132	Terminal Board	1	670-198	Wave Type Loading Spring	1			
670-133	Terminal Board Mounting Screw	4	670-201	Frame Screen with Mounting Screws	1			
670-134	Transformer	1	670-202	Thermostat with Spacers and Mounting Hardware	1			
670-135	Transformer Mounting Screw	4	670-203	Fan Wiring Harness	1			
670-136	Hoist Speed Selecting Contactor Mounting Screw	2						
670-137	Trolley Reversing Contactor Mounting Screws	2						
670-138	Jumper (Specify number required and Identification Number stamped on wire insulation or from wiring diagram)	1						
670-139	Line Connector	1						
670-140	Power Cable (Specify length required)	1						
670-141	Power Cable Connector	1						
670-142	Control Panel Mounting Screw	2						

NOTE: The Terminal Box and associated parts shown as mounting on side of motor, plus the additional control parts shown mounting on Control Panel (670-130) are for a Hoist with Single Speed Trolley.

Continued on Page 25

Table 10. Parts List-Plain, Geared & Motor Driven Trolley

Key No.	Part Name	No. Req'd	Key No.	Part Name	No. Req'd.	Key No.	Part Name	No. Req'd.
670-300	Control Station Chain Attaching Link (Specify number required).	—	670-338	Trackwheel Pinion Shaft	1	670-387	Contacting Attaching Screw	3
670-301	Control Station Chain (Specify length required).	—	670-339	Trackwheel Pinion Spacer	1	670-388	Contacting Attaching Screw Lockwasher	3
670-302	Control Station Cord Clip (Specify No. Req'd.)	—	670-340	Pinion Bearing Sleeve	1	670-390	Transformer	1
670-303	Contacting Jumper	3	670-341	Pinion Shaft Ball Bearing	2	670-391	Transformer Attaching Screw	2
670-304	Hoist Suspension Bolt	2	670-342	Intermediate Shaft Ball Bearing (Side Frame End)	1	670-392	Transformer Attaching Screw Lockwasher	2
670-305	Hoist Suspension Bolt Nut	4	670-343	Intermediate Shaft Ball Bearing (Motor End)	1	670-393	Transformer Attaching Screw Nut	2
670-306	Hoist Suspension Bolt Nut Cotter Pin	4	670-344	Driven Gear	1	670-395	Control Station Cord Connector, "O" Ring and Locknut	1
670-307	Spacer Washer (Specify number required)	—	670-345	Intermediate Pinion	1	670-396	Combination Power and Control Cord Connector, "O" Ring and Locknut	1
670-308	Trackwheel with Bearing Cups	4	670-346	Intermediate Gear	1	670-397	Control Station Cable Connector	4
670-309	Trackwheel Bearing Cup	8	670-347	Motor Pinion	1	670-398	Transformer Lead Connector (460 Volt Unit only)	1
670-310	Trackwheel Bearing Cone	8	670-348	Motor Pinion Pin	1	670-399	Control Station Chain Eyebolt	1
670-311	Trackwheel Bearing Seal Washer	8	670-349	Driven Gear Key	1	670-400	Control Station Chain Eyebolt Washer	2
670-312	Trackwheel Stud	4	670-350	Pinion Bearing Spacer	1	670-401	Control Station Chain Eyebolt Nut	2
670-313	Trackwheel Stud Collar	4	670-351	Intermediate Bearing Spacer	1	670-402	Ground Screw	2
670-314	Trackwheel Stud Nut	4	670-352	Intermediate Pinion Nut	1	670-403	Ground Screw Lockwasher	1
670-315	Trackwheel Gear	2	670-353	Intermediate Pinion Nut Lockwasher	1	670-405	Motor Lead Connector 1 Req'd for 230V Unit; 3 Req'd for 460V Unit	1
670-316	Trackwheel Gear Pin	4	670-354	Gear Housing	1	670-406	Trolley Reversing Contactor (See Page 33)	1
670-317	Trackwheel Gear Pinion	1	670-355	Gear Housing Gasket	1	670-407	Trolley Motor	1
670-318	Trackwheel Pinion Key	1	670-356	Gear Housing Screw	4	670-419	Trolley Motor Brake (Items 670-359 through 670-366 and 670-420)	1
670-319	Geared Side Frame (Does not include wheels)	1	670-357	Gear Housing Screw Lockwasher	4	670-420	Electric Brake (Items 670-421 through 670-423 and 670-425 through 670-431)	1
670-320	Plain Side Frame (Does not include wheels) 1 Req'd for Geared & Motor Driven Trolleys; 2 Req'd for Plain Trolley	1	670-358	Motor End Bell Gasket	1	670-421	Brake Base Plate with Studs	1
670-321	Handwheel Bracket with Bushings	1	670-359	Brake Hub	1	670-422	Brake Friction Disc	1
670-322	Handwheel Bushing	2	670-360	Brake Hub Snap Ring	1	670-423	Brake Armature with Plate	1
670-323	Handwheel Bracket Screw Lockwasher	3	670-361	Brake Attaching Screw	2	670-424	Brake Coil Jumper	2
670-324	Handwheel Bracket Screw	3	670-362	Brake Attaching Screw Lockwasher	2	670-425	Brake Coil	1
670-325	Handwheel Shaft	1	670-363	Motor End Cover and Brake Cover Gasket	2	670-426	Brake Coil Retainer Strap	1
670-326	Hand Chain Wheel Key	1	670-364	Brake Cover	1	670-427	Brake Field with Plate and Shading Coils	1
670-327	Hand Chain Wheel	1	670-365	Brake Cover Screw	3	670-428	Brake Spring	2
670-328	Trackwheel Pinion or Handwheel Shaft Nut Lockwasher	1 or 2	670-366	Brake Cover Screw Lockwasher	3	670-429	Brake Spacer Washer	10
670-329	Trackwheel Pinion or Handwheel Shaft Nut	1 or 2	670-367	Motor End Cover	1	670-430	Brake Stud Nut	2
670-330	Hand Chain Guide	1	670-368	Motor End Cover Screw	3	670-431	Shading Coil	2
670-331	Chain Guide Screw	1	670-369	Motor End Cover Screw Lockwasher	3	670-433	Brake Lead Wire Nut	2
670-332	Chain Guide Screw Washer	1	670-370	Terminal Box, Cover and Gasket	1			
670-333	Chain Guide Screw Nut Lockwasher	1	670-371	Terminal Board	1			
670-334	Chain Guide Screw Nut	1	670-372	Terminal Board	1			
670-335	Hand Chain and Connecting Link (Specify length required)	1	670-373	Terminal Box Attaching Screw	1			
670-336	Hand Chain Connecting Link	1	670-374	Terminal Box Attaching Screw Lockwasher	1			
670-337	Trackwheel Pinion Spacer Washer (3 Ton Only—specify number required) (not shown)	—	670-375	Terminal Board Spacer	2			
			670-376	Terminal Box and Board Attaching Screw	2			
			670-377	Terminal Box and Board Attaching Screw Lockwasher	2			
			670-378	Power Cable Connector	1			
			670-379	Power Cable	1			
			670-380	Junction Box Gasket	1			
			670-381	Contacting Box, Cover with Gasket & Screws	1			
			670-382	Contacting Box Attaching Screw	3			
			670-383	Contacting Box Attaching Screw Lockwasher	3			
			670-384	Contacting Box Cover Attaching Screw	2			
			670-385A	Combination Power and Control Cord	1			

NOTE: Hoists that are supplied with the Trolley contacting mounted on the control panel inside hoist use a type SD contacting. Individual components are not available for the repair of this contacting. (Key No. 670-502).

Figure 14. Parts Illustration—Exploded View—
Series 670 Electric Chain Hoist
—2 thru 6 ton

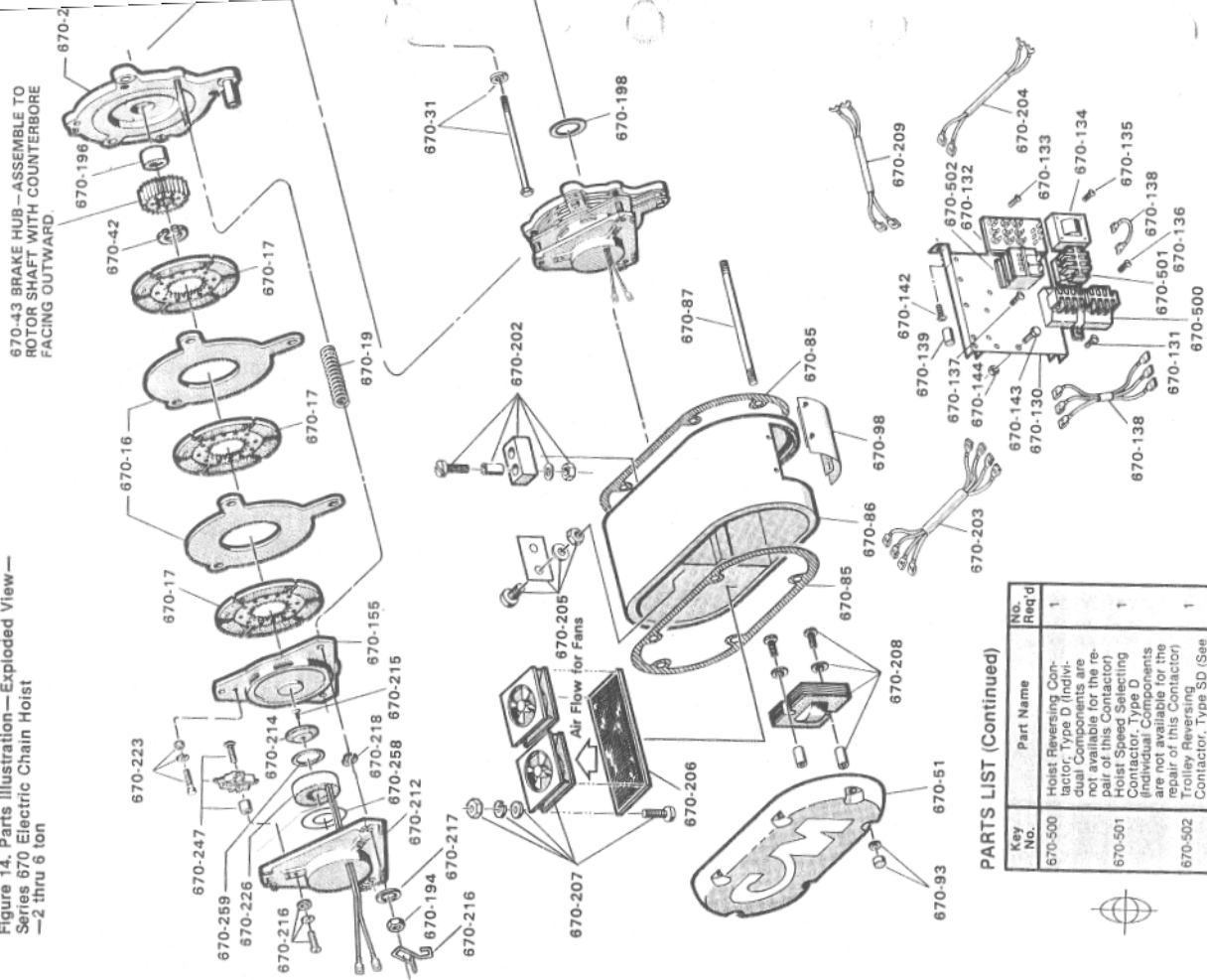

PARTS LIST (Continued)

Key No.	Part Name	No. Req'd
670-500	Hoist Reversing Contactor, Type D (Individual Components are not available for the repair of this Contactor) Hoist Reversing Contactor, Type D (Individual Components are not available for the repair of this Contactor) Contactor, Type SD (See Note Page 25) Complete with Terminal and Coil Jumpers	1
670-501	Hoist Reversing Contactor, Type D (Individual Components are not available for the repair of this Contactor)	1
670-502	Hoist Reversing Contactor, Type SD (See Note Page 25) Complete with Terminal and Coil Jumpers	1

Figure 15. Parts Illustration—Exploded View—
Series 670 Plain, Geared and Motor Driven Trolleys

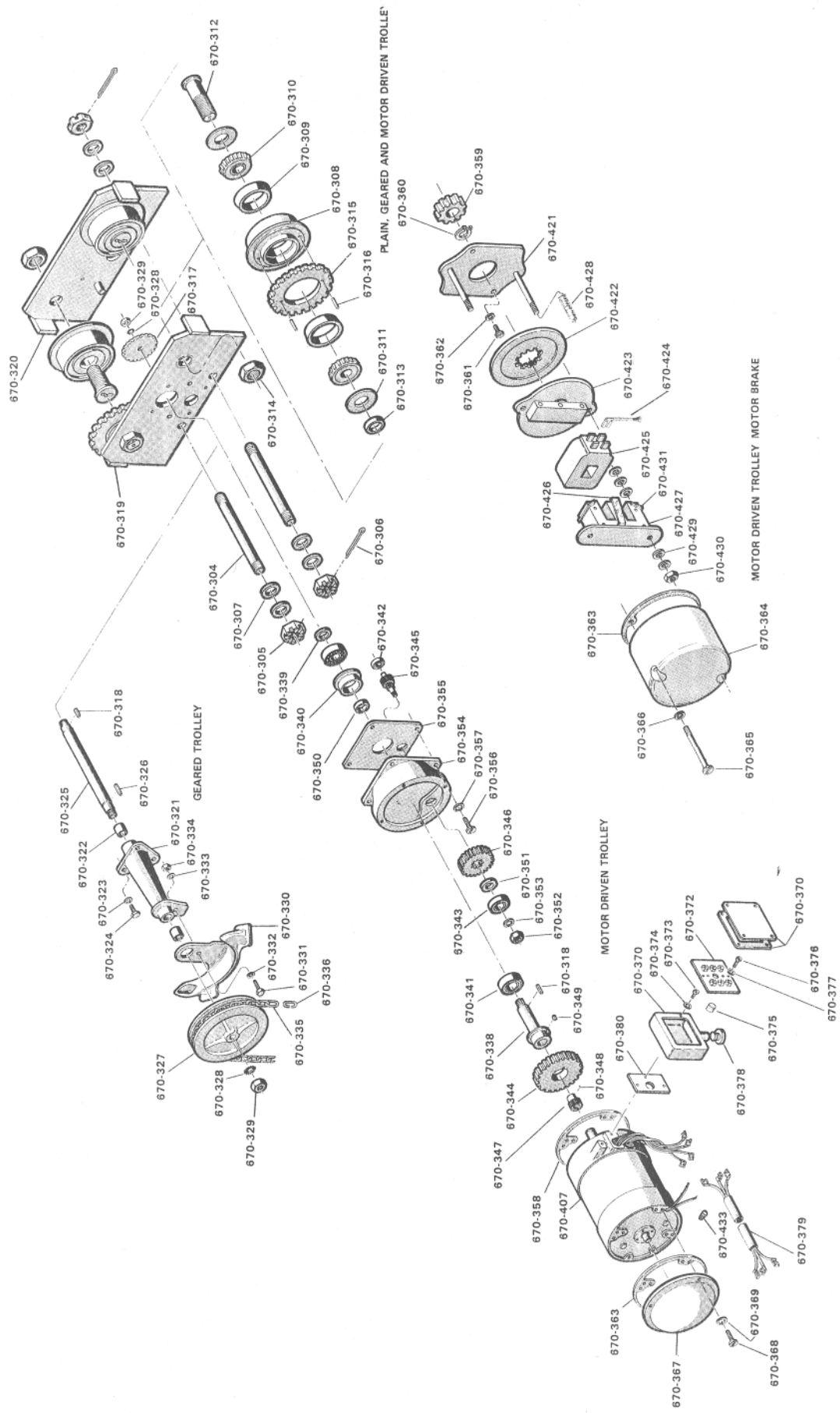
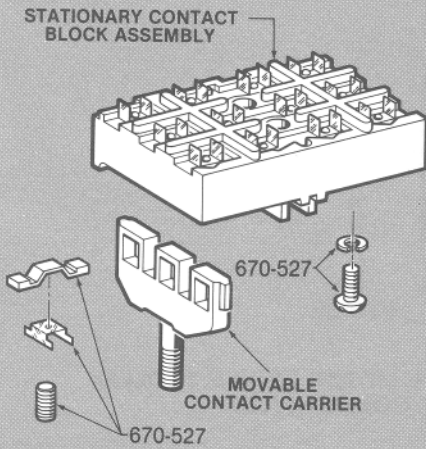

Figure 16. Parts List and Exploded View, Separate M.D.T. Contactor, Chain Container and Lug Suspension

SEPARATE MOTOR DRIVEN TROLLEY REVERSING CONTACTOR (TYPE D)



PARTS LIST

Key No.	Part Name	No. Req'd.
670-406*	Reversing Contactor (Complete)	1
670-527	Contact Kit (includes 12 Stationary Contact Screws, 12 Lockwashers, 6 Retainer Clips, 6 Springs and 6 Movable Contacts)	1

*Other than for 670-527, individual components are not available for the repair of this contactor.

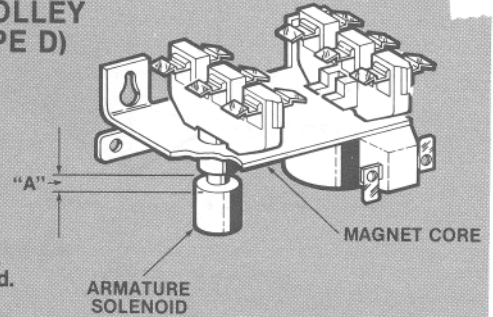

ADJUSTMENT: IF THE CONTACTOR IS DISASSEMBLED TO REMOVE THE MOVABLE CONTACT CARRIER, THE ARMATURE SOLENOID MAY BE ADJUSTED BY SCREWING THE ARMATURE WITHIN "A" DIMENSION OF THE MAGNET CORE AND LOCKING WITH SLOTTED NUT TO 20 LB.-IN. TORQUE. "A" DIMENSION DEPENDS UPON THE SERIES STAMPED ON THE CONTACTOR NAMEPLATE. FOR SERIES "C" CONTACTORS "A" = 15/64". FOR SERIES "D" CONTACTORS "A" = 19/64".

CHAIN CONTAINER PARTS LIST

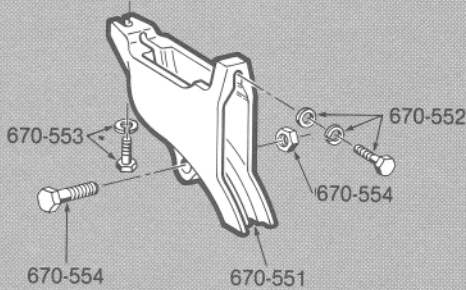

NOTE: THE CHAIN CONTAINER FURNISHED BY CM IS ENGINEERED AND DESIGNED FOR USE WITH A SERIES 670 HOIST OF SPECIFIC SIZE AND LIFT. HOIST MALFUNCTION AND DAMAGE TO THE UNIT CAN OCCUR IF OTHER THAN PROPERLY ENGINEERED CHAIN CONTAINER IS USED.

Key No.	Part Name	No. Req'd.
670-550	Chain Container A = 10-7/16 for single reeved units with 20 ft. lift A = 18-9/16 for double reeved with 20 ft. lift and single reeved units with 40 ft. lift	1
670-551	Chain Chute	1
670-552	Chute and Container Screw and Washer (2)	1
670-553	Chute Mounting Screw and Washer	1
670-554	Container Mounting Screw and Nut	1

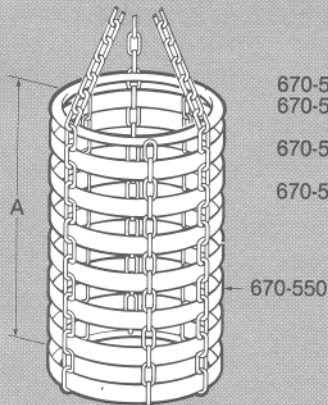

LUG SUSPENSION PARTS LIST

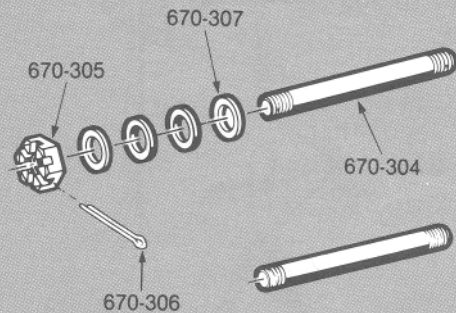

Key No.	Part Name	No. Req'd.
670-432	Lug Suspension (Items 670-304 thru 670-307)	1
670-304	Hoist Suspension Bolt (Specify length of bolt)	2
670-305	Hoist Suspension Bolt Nut	4
670-306	Hoist Suspension Bolt Nut Cotter Pin	4
670-307	Spacer Washer (Specify No. Req'd.)	—

Figure 17. Parts Illustration-Exploded View Series 670 Control Stations and Separate Motor Driven Trolley Control Components (See Table 10 for Parts List)

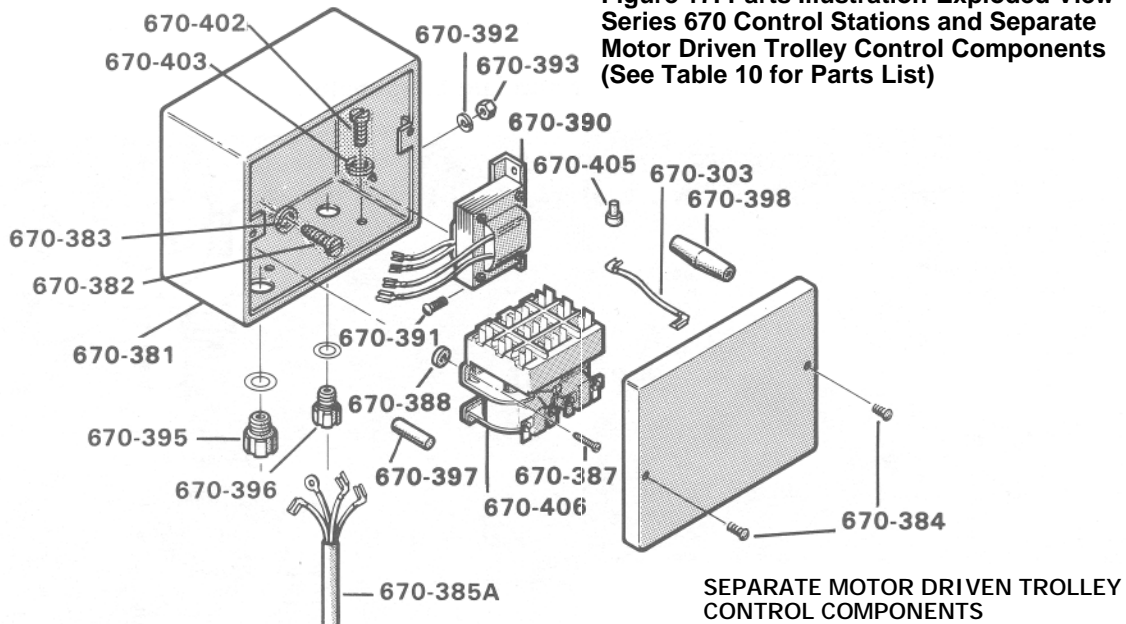

For more information contact:
 American Crane & Equipment Corp.
 Authorized Distributor
 Tel: 877-503-2972
 Fax: 484-945-0430
 sales@americancrane.com
 www.americancrane.com

